



Note: All estimates and material lists are based off of major manufacturer installation requirements and standard materials with the intent to meet building code requirements.

Quick Estimate, Material List & Roof Plan

RE: Property Description and Address

Page 1 of 5

Scope of Work Included in Estimate:

- 1) Remove and dispose of existing roofing.
- 2) Inspect plywood deck and replace any damaged decking. If any decking requires replacement an additional charge of \$1.45 (varies per contractor) per square foot will be incurred.
- 3) Install 20" galvanized valley flashings at all applicable details.
- 4) Install Ice & Water Shield along eaves 24" inside warm wall and in the valleys.
- 5) Install pre-finished 2"x2" metal drip edge on eaves & rakes.
- 6) Install one ply of 30 lb. felt underlayment.
- 7) Install shingle starter with sealant (seals shingles along eaves & rakes).
- 8) Install new pre-finished roof vents.
- 9) Install new neoprene pipe flashings at all plumbing vents.
- 10) Check all wall and roof penetration flashings and repair as necessary to assure a watertight roof covering.
- 11) Install Lifetime Architectural Class A Laminated Shingles. Owner selects color.
- 12) Install valleys in a closed fashion.
- 13) Install manufacturer hip and ridge cap in a double covered fashion.
- 14) Building permits (\$250.00 included in budget).
- 15) Appropriate length roofing 6-nails shall be used as fasteners in lieu of staples.
- 16) Clean and remove all related debris.
- 17) Budget Estimate is **\$11,370.00**. (3.5% taxes included, varies per region)
- 18) Manufacturer Standard Warranty
- 19) Install new prefinished ogee style seamless gutters and downspouts, (Owner selects color) is an additional \$1,524.00.
- 20) Install 1 new Velux C06 Fixed deck mount glass skylight, curb and flashing kit is an additional \$1,483.00. (no interior work included)



Roofing Material List:

| <u>Item</u> | <u>Quantity</u> |
|------------------------------|------------------------|
| asphalt shingles | 20 squares |
| hip & ridge shingles 25lf | 4 bundles |
| shingle starter 120lf | 2 bundles |
| 30# felt underlayment 2sq | 10 rolls |
| ice & water guard 2sq | 5 rolls |
| 2x2 metal drip edge 10' | 32 pieces |
| valley metal 20"x50' | 1 roll |
| step flashing 4"x4"x8" | 3 bundles |
| roof vents | 9 each |
| 1-3 inch plumbing pipe jacks | 7 each |
| 4 inch plumbing pipe jacks | 1 each |
| 1-1/4" coil roofing nails | 3 boxes |
| 1-3/4" coil roofing nails | 1 box |
| roofing cement 10oz | 2 tubes |
| 1-1/4" plastic caps | 1 box |

sq=squares

lf=lineal feet

Project Address

Report: 13192316

PITCH DIAGRAM

Pitch values are shown in inches per foot, and arrows indicate slope direction. The predominant pitch on this roof is 6/12.

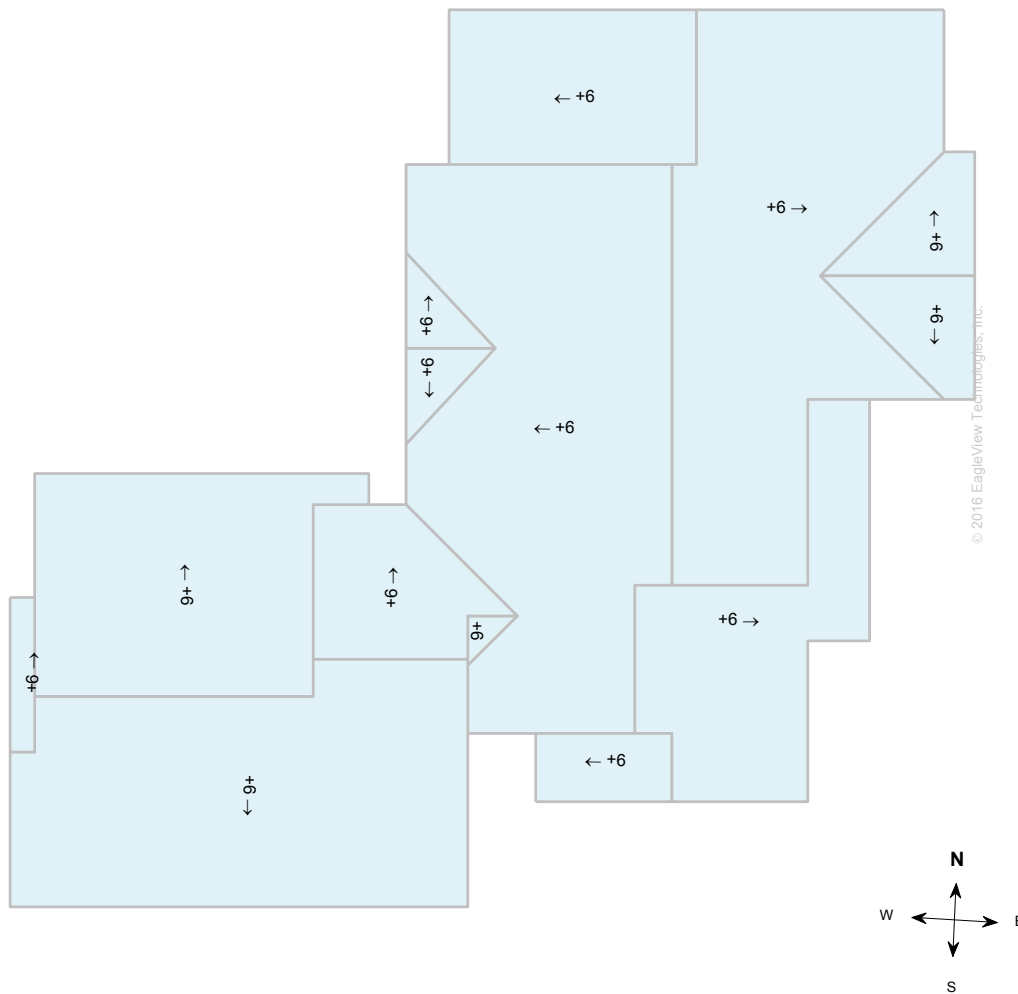

Note: This diagram contains labeled pitches for facet areas larger than 20 square feet. In some cases, pitch labels have been removed for readability. Blue shading indicates a pitch of 3/12 and greater.

NOTES DIAGRAM

Roof facets are labeled from smallest to largest (A to Z) for easy reference.

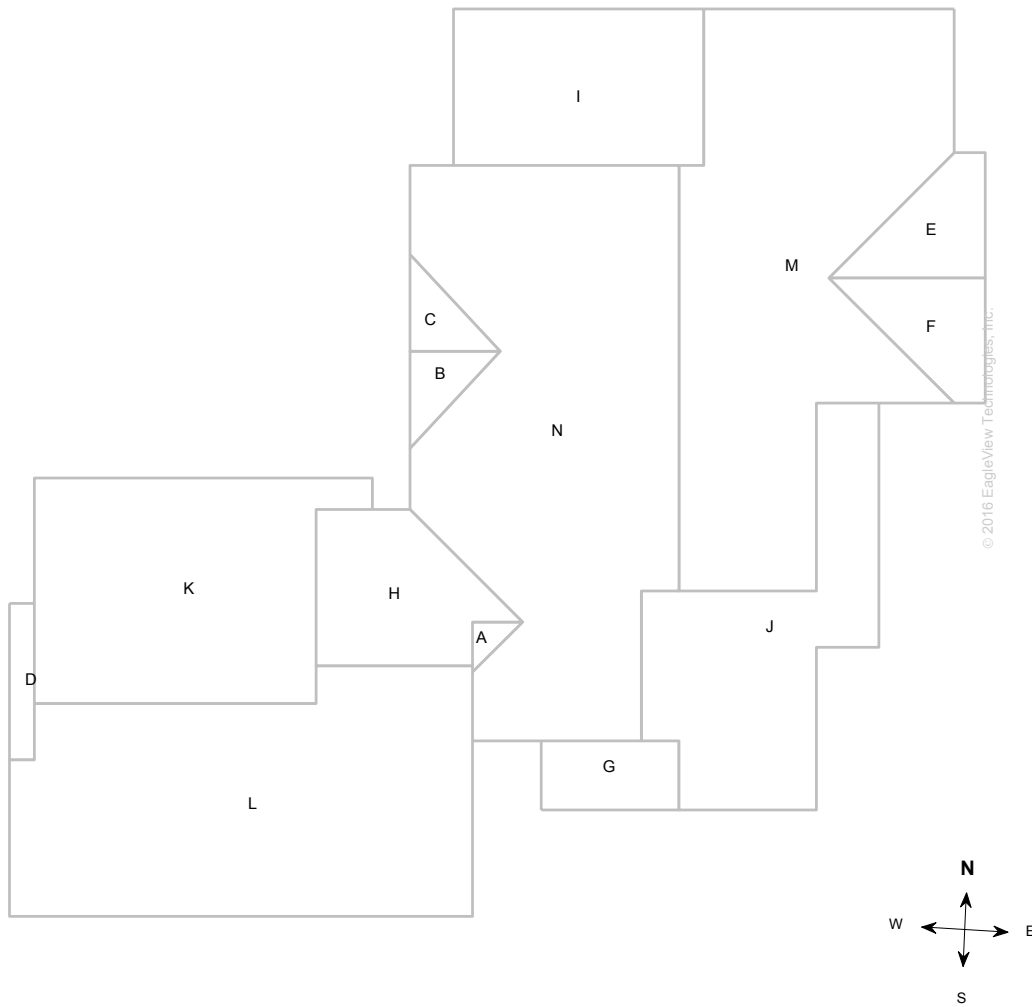

© 2016 EagleView Technologies, Inc.